

1 TYPICAL PERIMETER CONDITION 1  
N.T.S

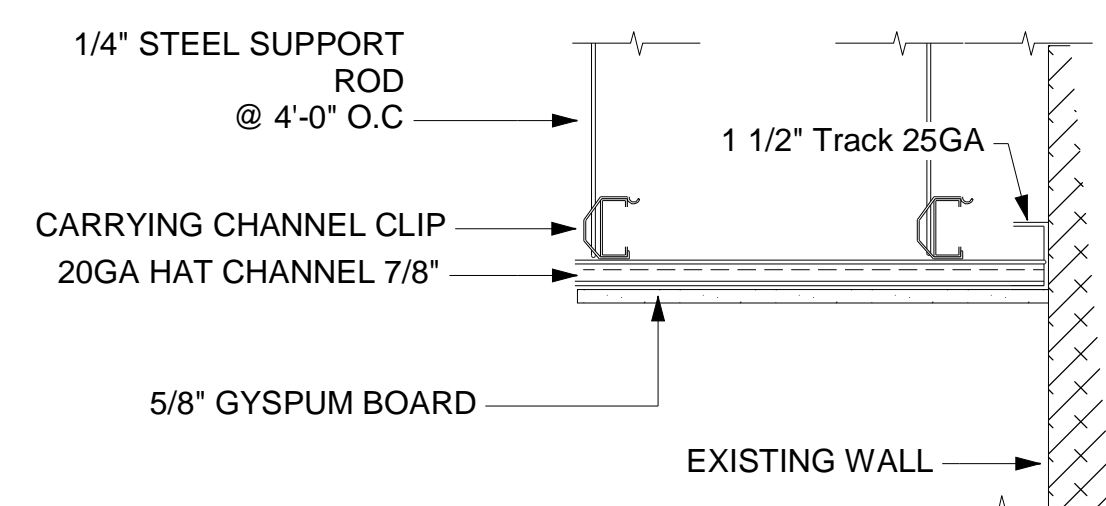

2 TYPICAL PERIMETER CONDITION 2  
N.T.S

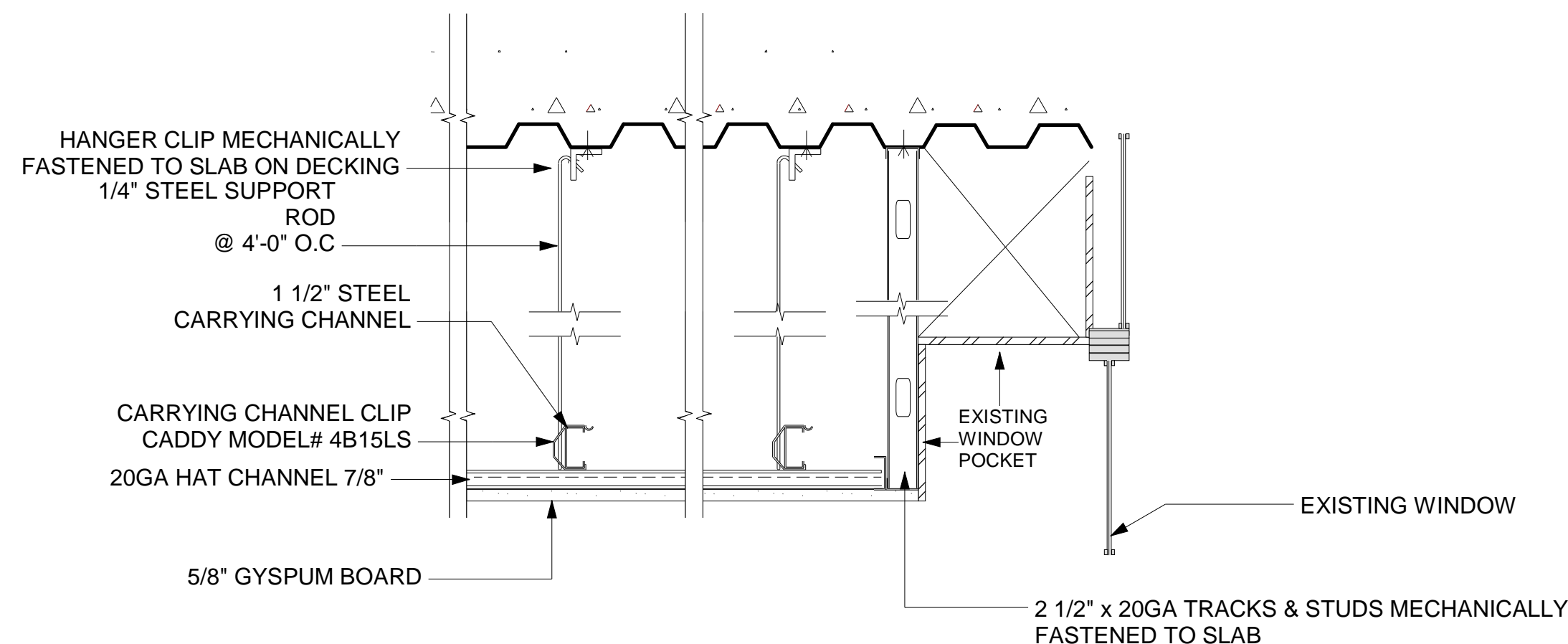

3 DETAIL@ EXISTING WINDOW POCKET  
N.T.S

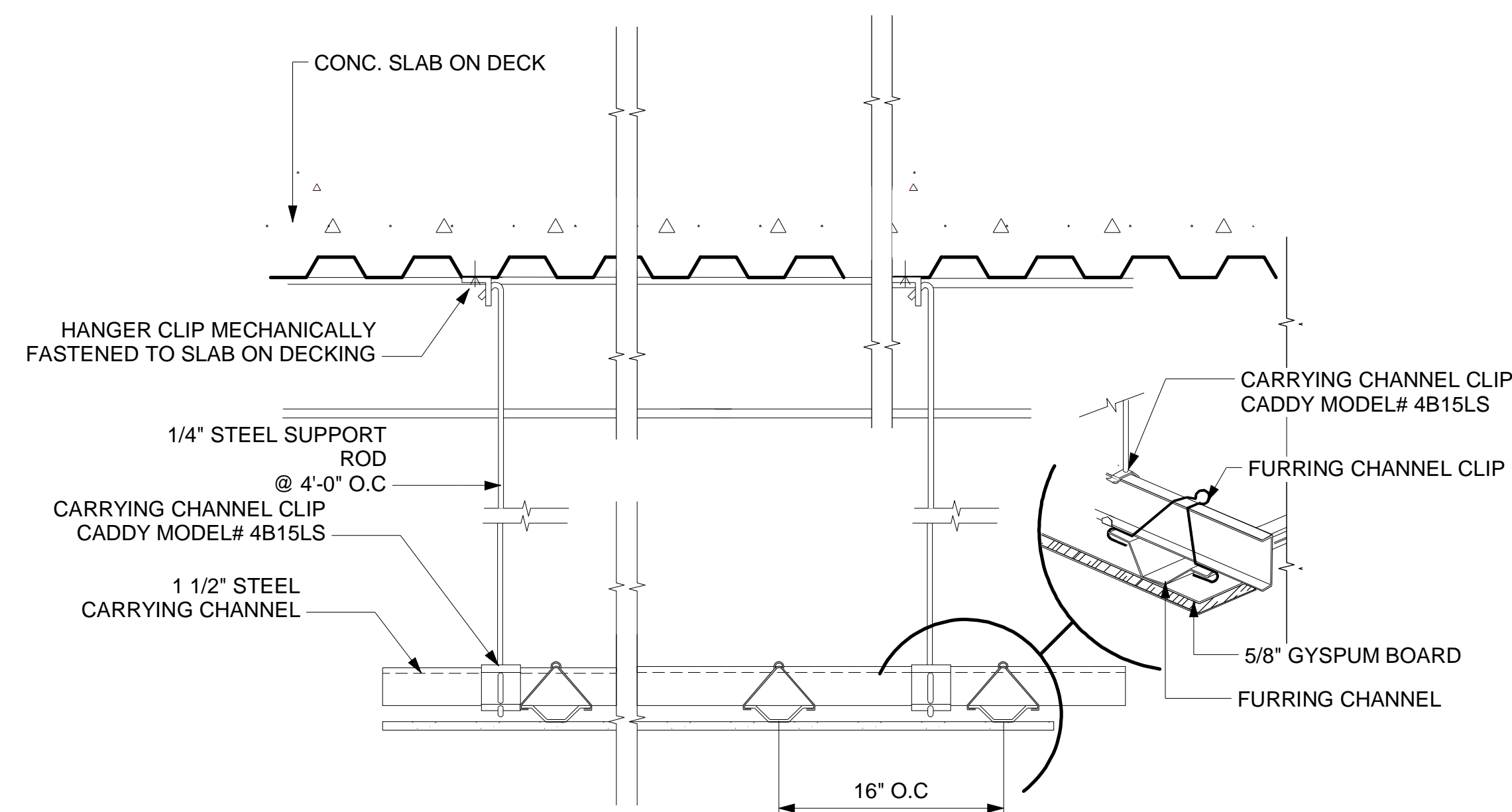

5 TYPICAL CEILING SUSPENSION DETAILS  
N.T.S

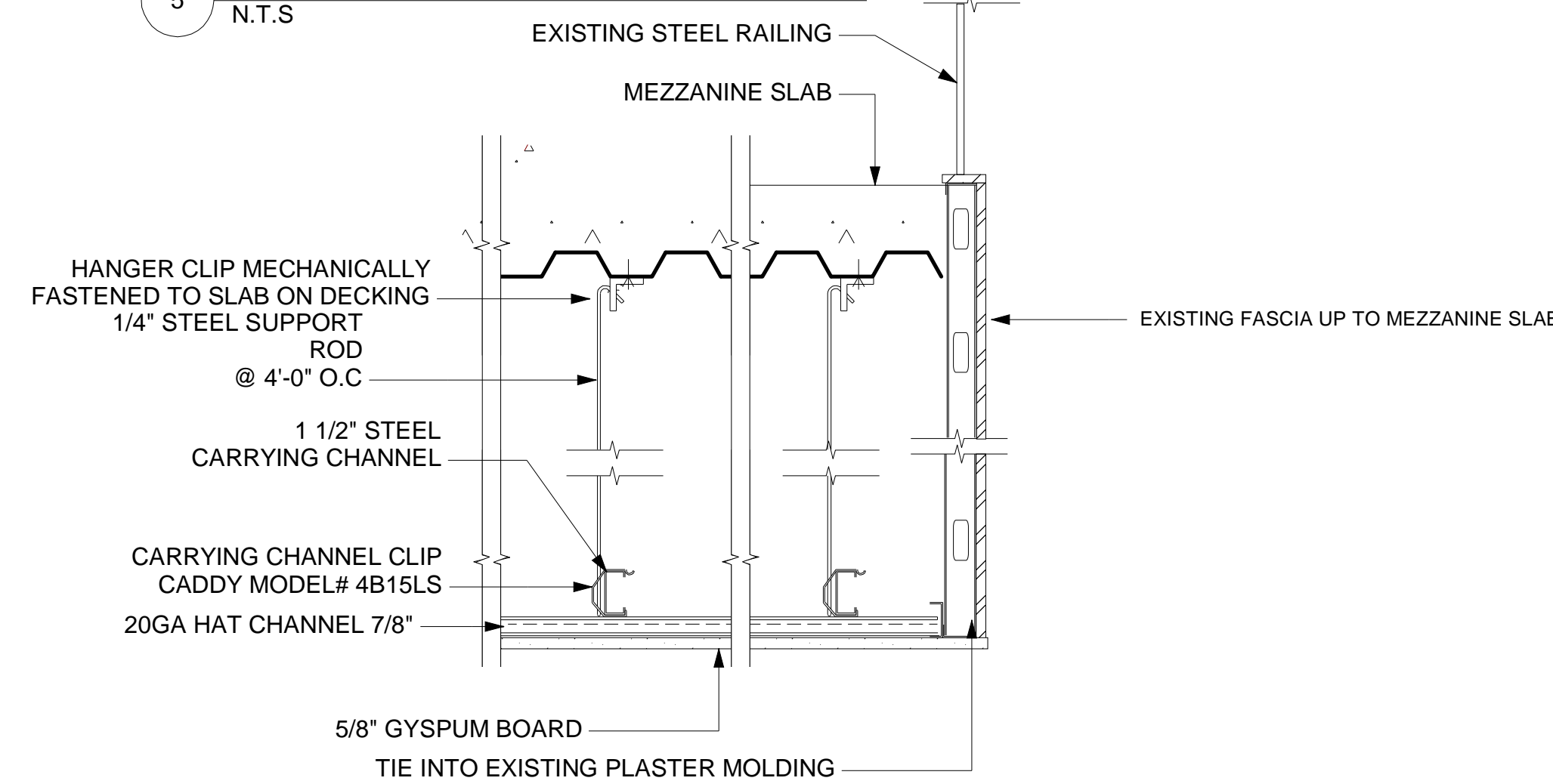

4 DETAIL@ EXISTING FASCIA BELOW MEZZANINE RAILING  
N.T.S

| LEGEND |   |
|--------|---|
|        | LIGHT FIXTURE( SHOWN FOR REFERENCE-LAY OUT TO BE VERIFIED IN FEILD) |
|        | ACCESS DOOR( SHOWN FOR REFERENCE-LOCATIONS TO BE VERIFIED IN FEILD) |
|        | AMERICAN GLASS COMPANY PENDANT LIGHT 14"                            |
|        | AMERICAN GLASS COMPANY PENDANT LIGHT 36"                            |

**CNA**  
enterprises, Inc.

## LOBBY LEVEL1 CEILING FRAMING

FASION INSTITUTE OF TECHNOLOGY  
"A" BUILDING LOBBY RENOVATION

Drawn by: **Mark Tarver**

Date: **06/20/2011**

**CFP-0**

SCALE  
1/4" = 1'-0"

CNA Enterprises, Inc  
33-56 11th Street  
Long Island City 11106  
phone 718-533-8181  
fax 718-533-8225